

Sasebo Port (Uragashira area)

Location	Hariokita-machi, Sasebo City, Nagasaki
Nearest Station	JR Huistenbosch Station : 10minutes by car
Access	JR Huistenbosch Station : 10minutes by car Hakata Station : 113minutes by Limited Express
Facilities	Total Floor Space CIQ:6,496㎡, 1305㎡(Customs 8 booths, Immigration 18 booths, Quarantine 1 booth)
Capacity	• Length:370 • Water Depth : -10.0m • Tidal Range:3.30m
Others	Harbor Pilot : Required(Compulsory Area)
Welcome Events	Welcome Speech, Presentation of Bouquets and Gifts, Show performance
Tourist Information	Information Desk is located in the Terminal (Guide map, tourism brochure etc.)
City Tours	



2019

Port of SASEBO



SASEBO

◆ Location of the Port of Sasebo

Port of
SASEBO

P1



Mainland westernmost point (Kozaki bana)



● the westernmost in mainland → Near East Asian Area (China • Korea • Taiwan) ● halfway point between Nagasaki and Hakata → Gateway of Northern part of West Kyushu (Northern Nagasaki, Western Saga)

◆ Sasebo Port (from harbor entrance to Miura/Uragashira) *Port of SASEBO* P2

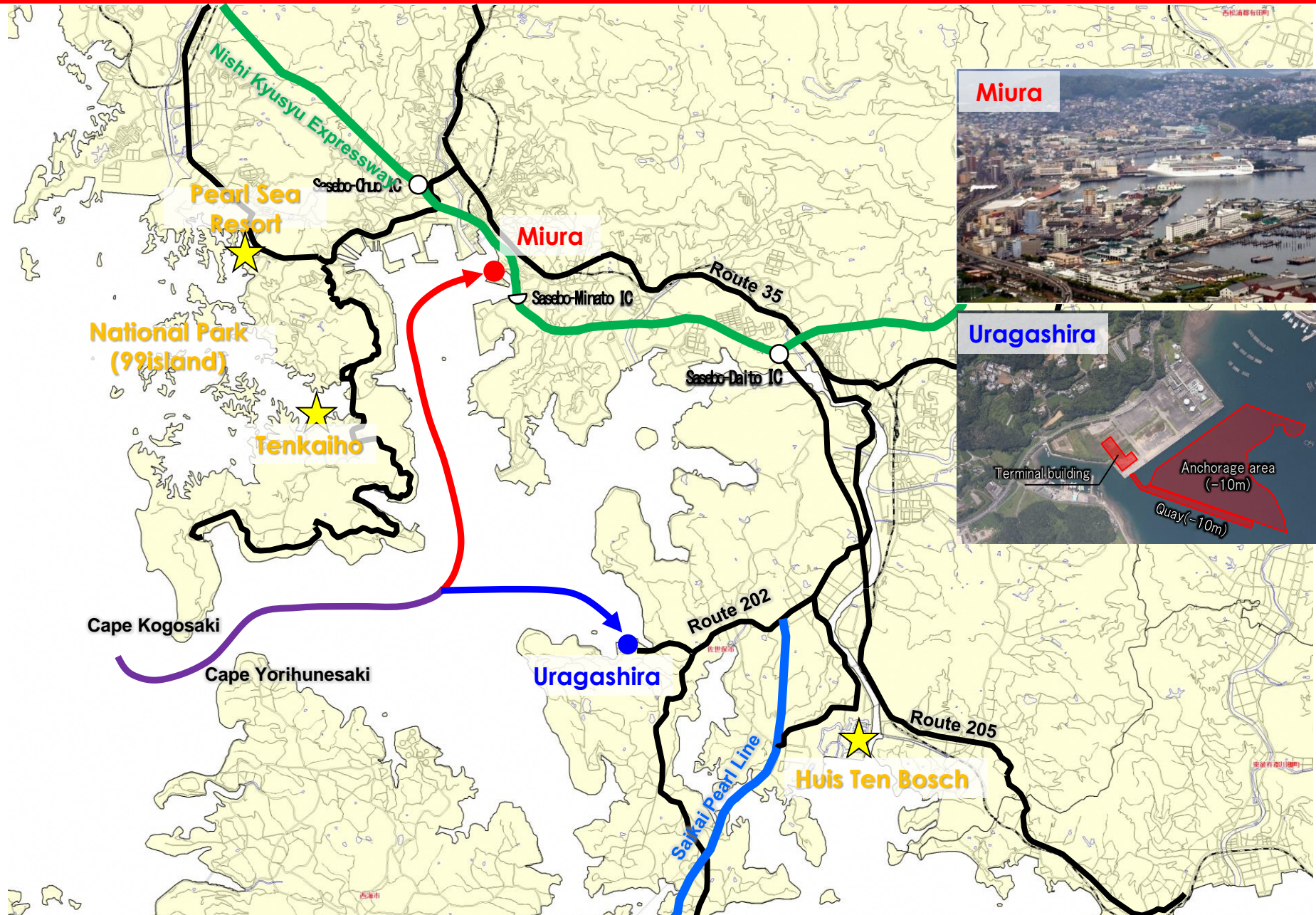



Sightseeing Spot
(Huis Ten Bosch)

Cruise Ship Berths
(Uragashira area)

Harbor entrance

Route

Cruise Ship Berths
(Miura area)

Sightseeing Spot
(National Park)

Sasebo Downtown

◆ MIURA Area(Center of Sasebo city)

Port of
SASEBO

P4

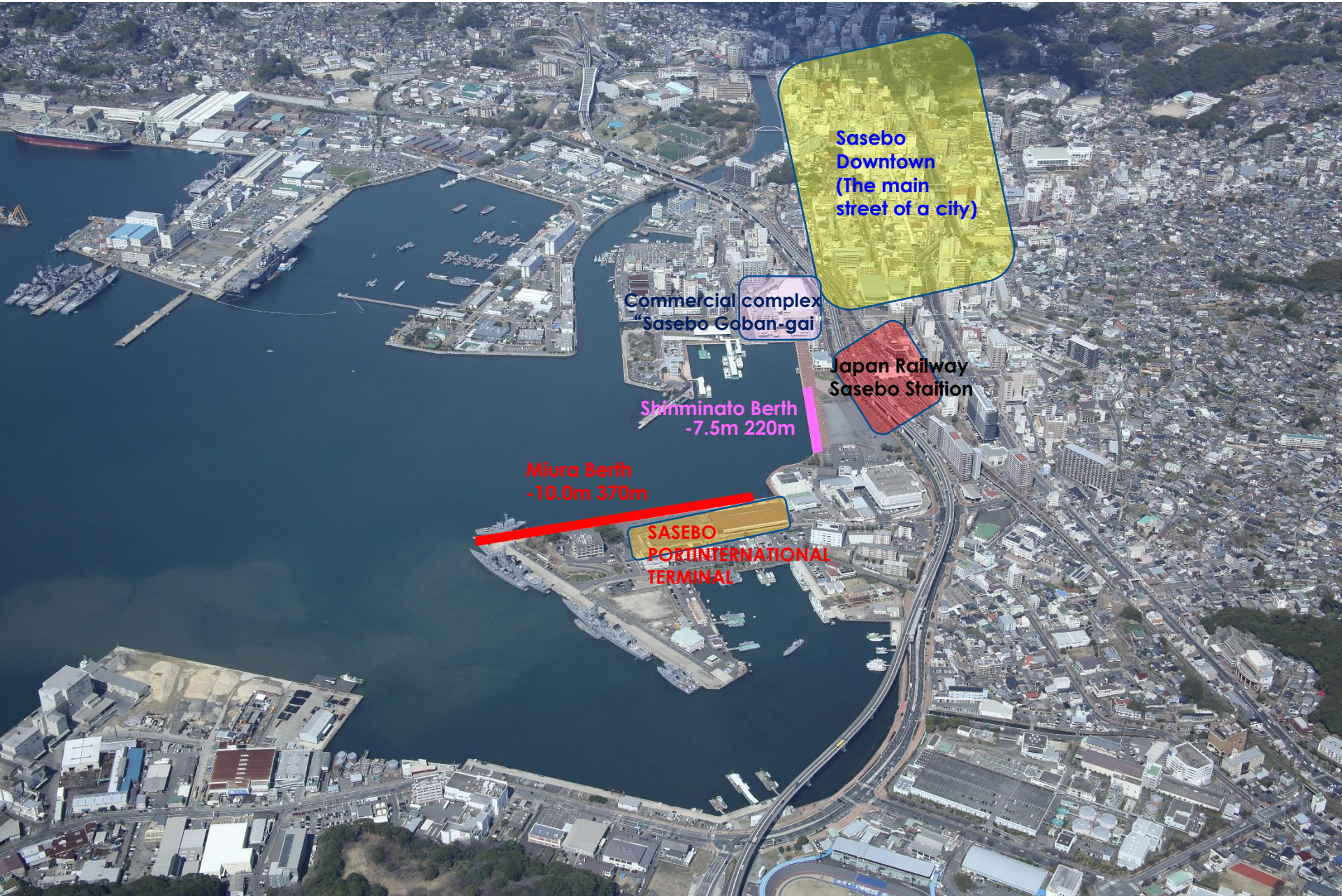

◆ Prime location of the port of Sasebo, near downtown ^{Port of SASEBO} P5

- Situated in the key traffic area for public transportation such as railroads, buses and ships in the northern part of Nagasaki prefecture where individuals can easily enjoy sightseeing.
- Within walking distance there are a commercial complex and a shopping arcade which is said to be the liveliest shopping street in Japan. Also you can easily enjoy strolling in the street.
- With very near the Expressway entrance, you can smoothly depart for the optional sightseeing tours to other city.

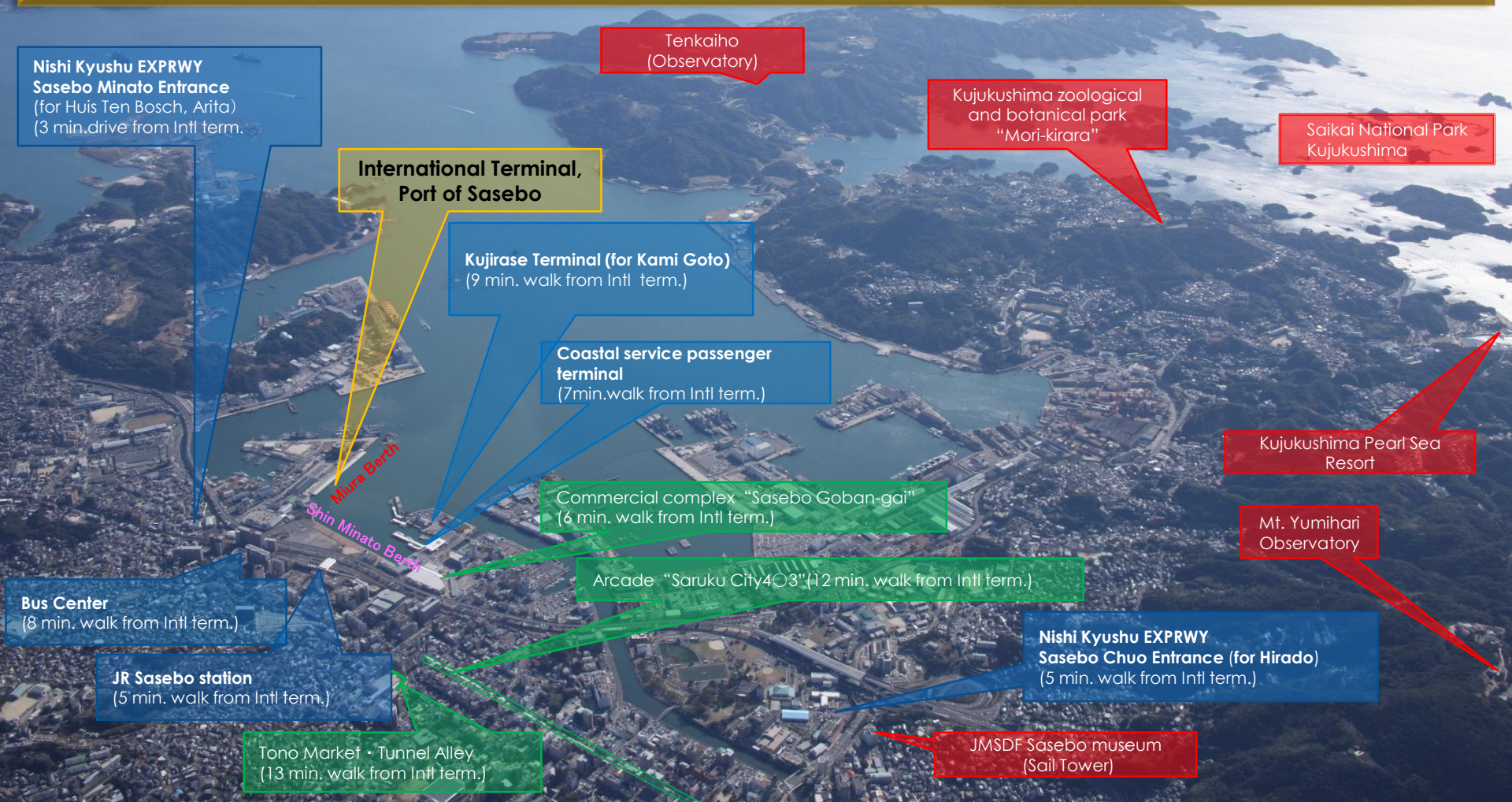

P6



- 20min by JR rapid train to Huis Ten Bosch, 18 min by shuttle bus to Pearl Sea Resort, regular tour bus stand at port
- within 1 hour drive to sightseeing areas like Hirado, Ureshino and Arita, etc.
- Approx. 80 min by high speed ship to Kami Goto (Arikawa)

○55 min. by jumbo taxi to Nagasaki Airport and 1 hour 40 min. by expressway bus to Fukuoka Airport.
○1 hour 50 min. by JR express to Hakata station, 1 hour 44min by expressway bus to Fukuoka Tenjin



SASEBO PORT INTERNATIONAL TERMINAL

About 400m

About 550m

About 950m

5min. by walk

5min. by walk

3min. by Car



**SASEBO Station
(Japan Railway)**



Commercial complex



**Nishi Kyushu EXPRWY
entrance**

◆ Tour bus parking area and flow

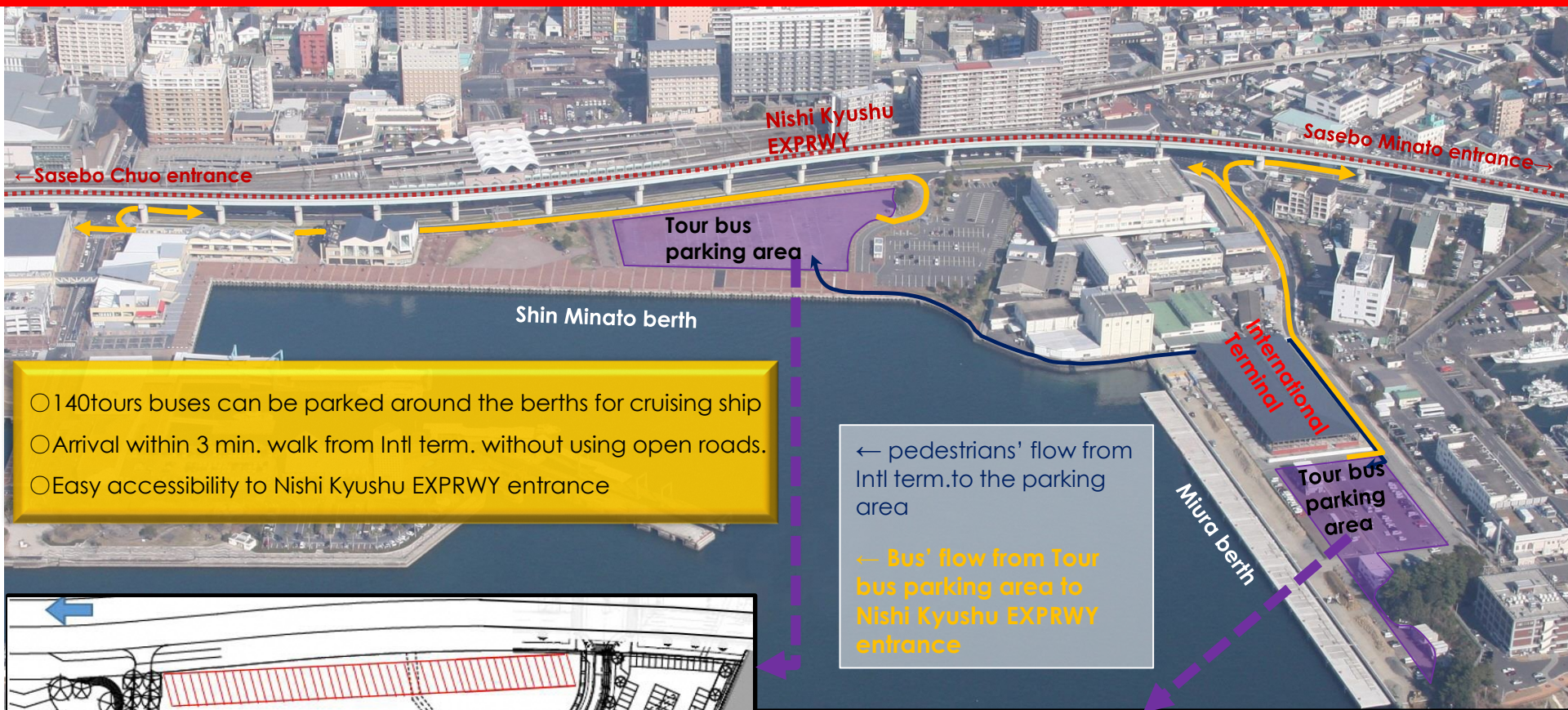

- 140 tour buses can be parked around the berths for cruising ship
- Arrival within 3 min. walk from Intl term. without using open roads.
- Easy accessibility to Nishi Kyushu EXPRWY entrance

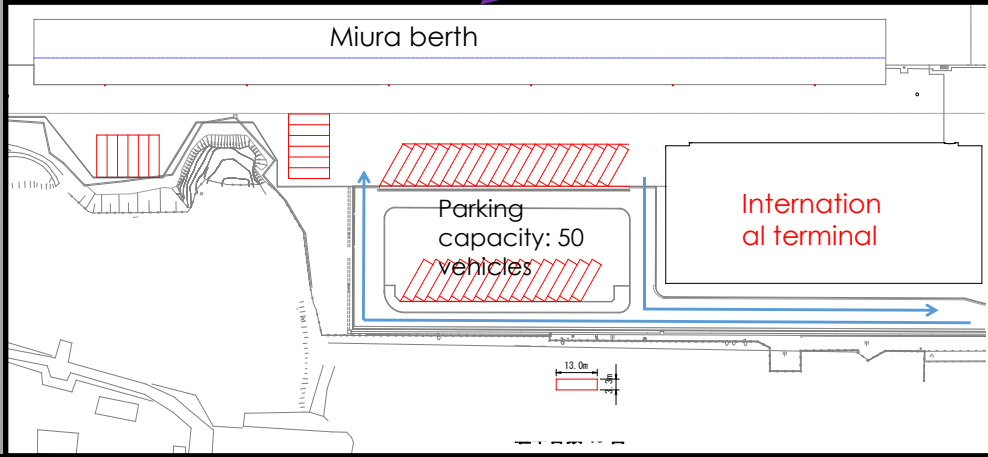
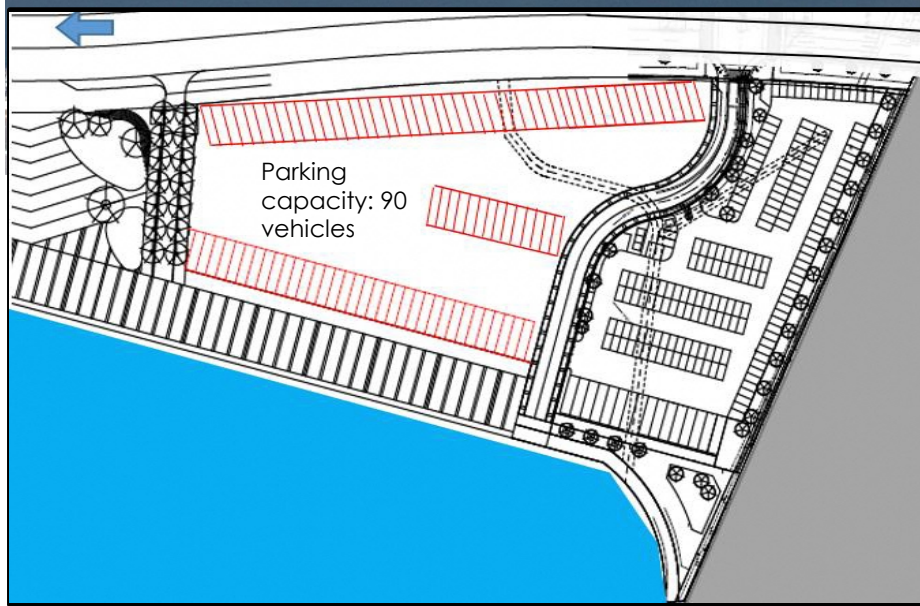

◆ Port of Sasebo INT'L Terminal ~facility overview and flows~ P9

Port of
SASEBO



Building Outline

Item	Overview
Site area	6,408㎡
Building area	4,786㎡
Total Floor Area	1F 4,336㎡
	2F 613㎡
	合計 4,949㎡
No. of stories	Partially 2 stories
Max. Height above running surface	12.83m

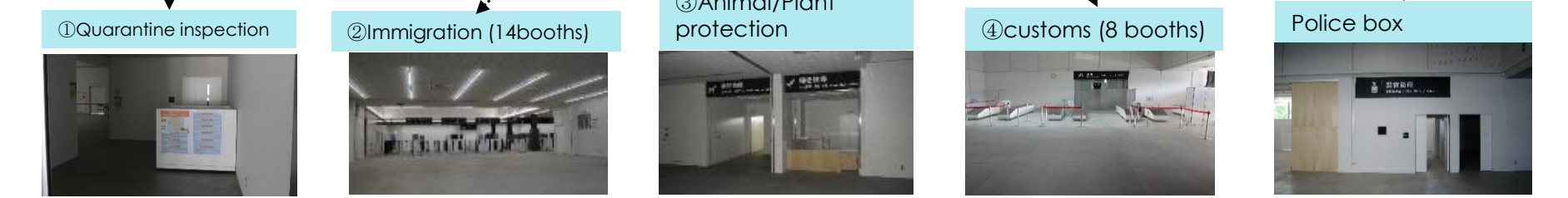
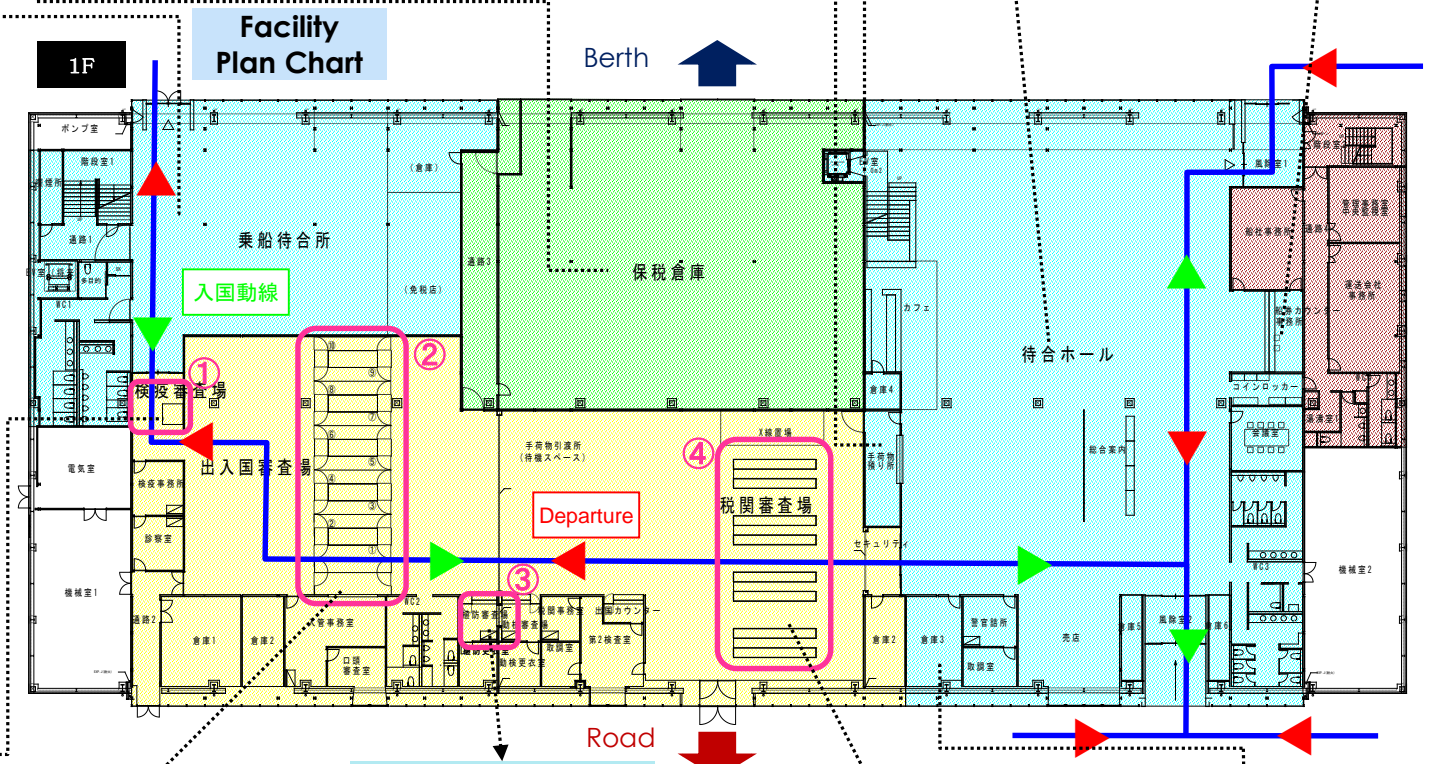
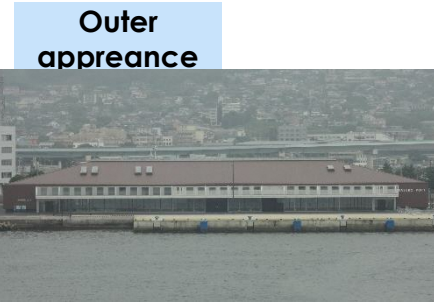

◆Cruise Ship berths (Uragashira area)

Port of
SASEBO

P10

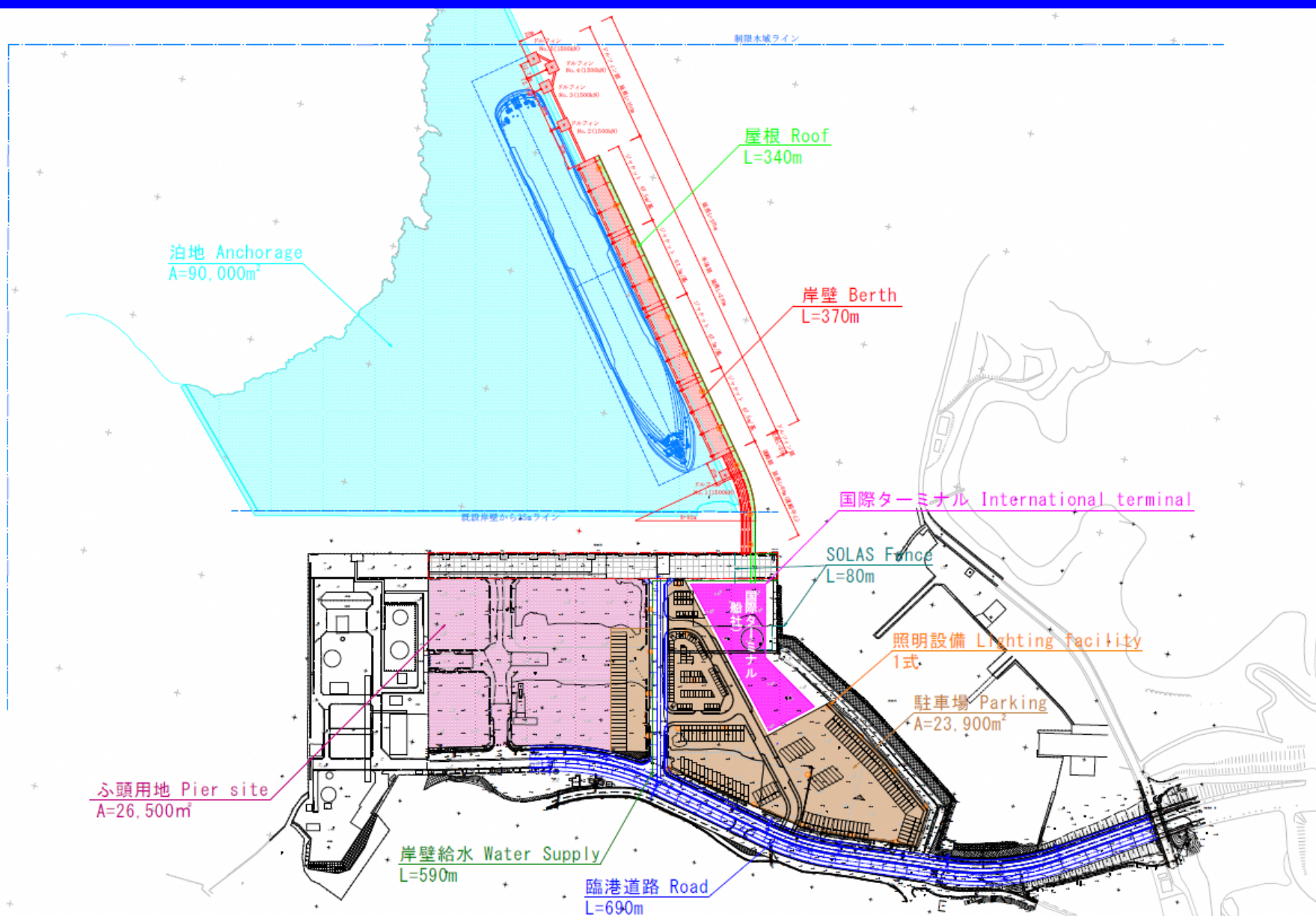

◆Cruise Ship berths (Uragashira area)

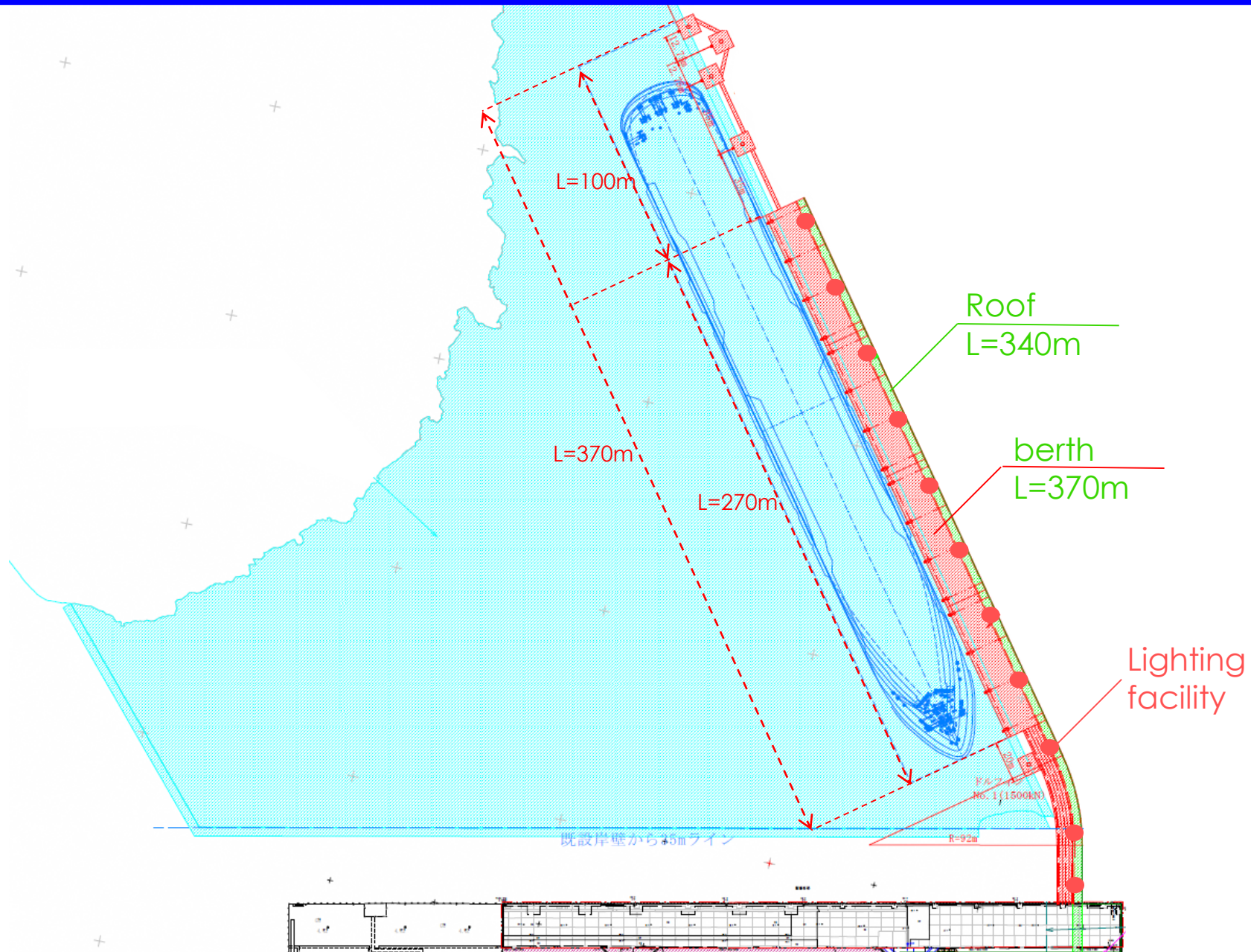

◆Cruise Ship berths (Uragashira area)

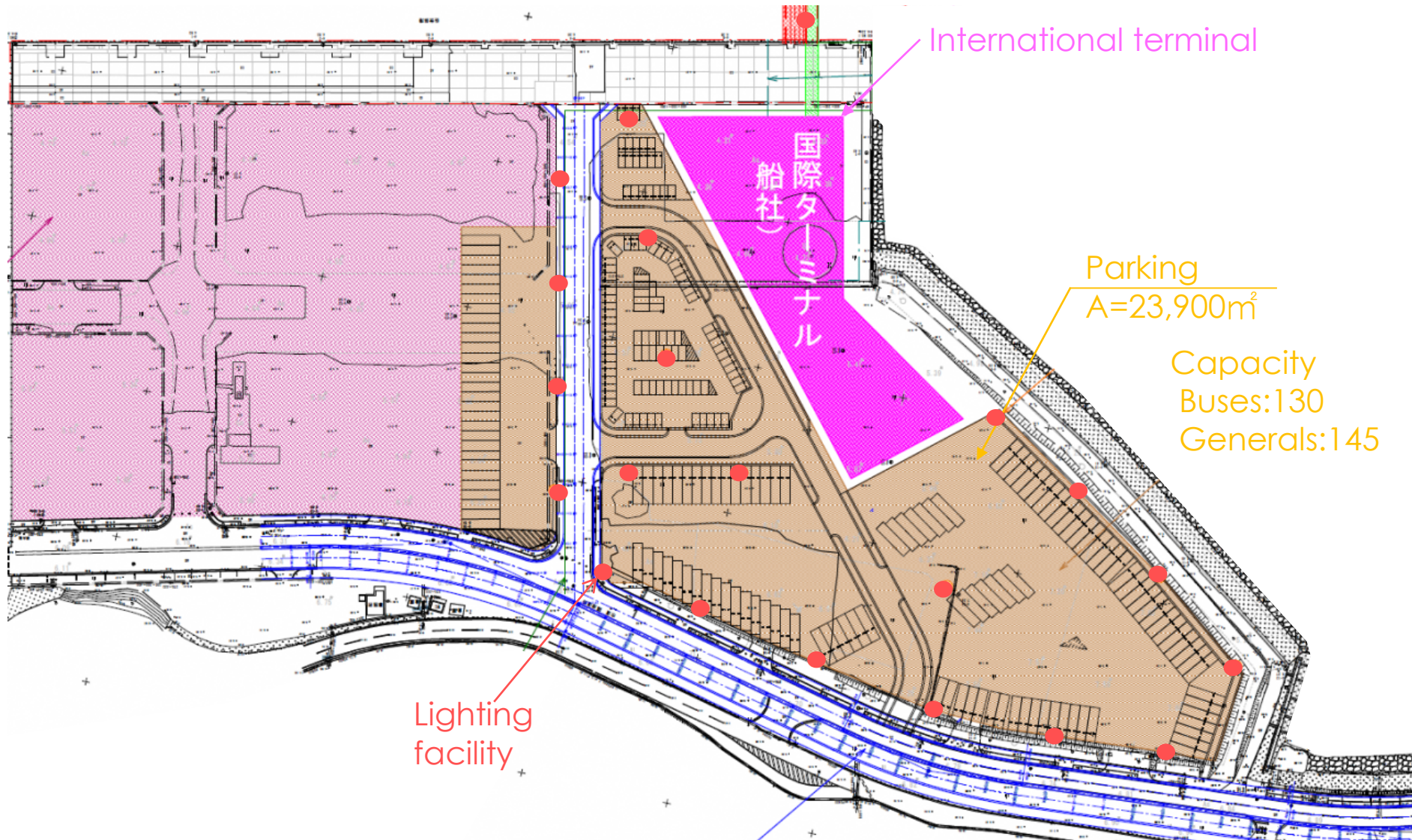

◆ URAGASHIRA Area(Near HTB)

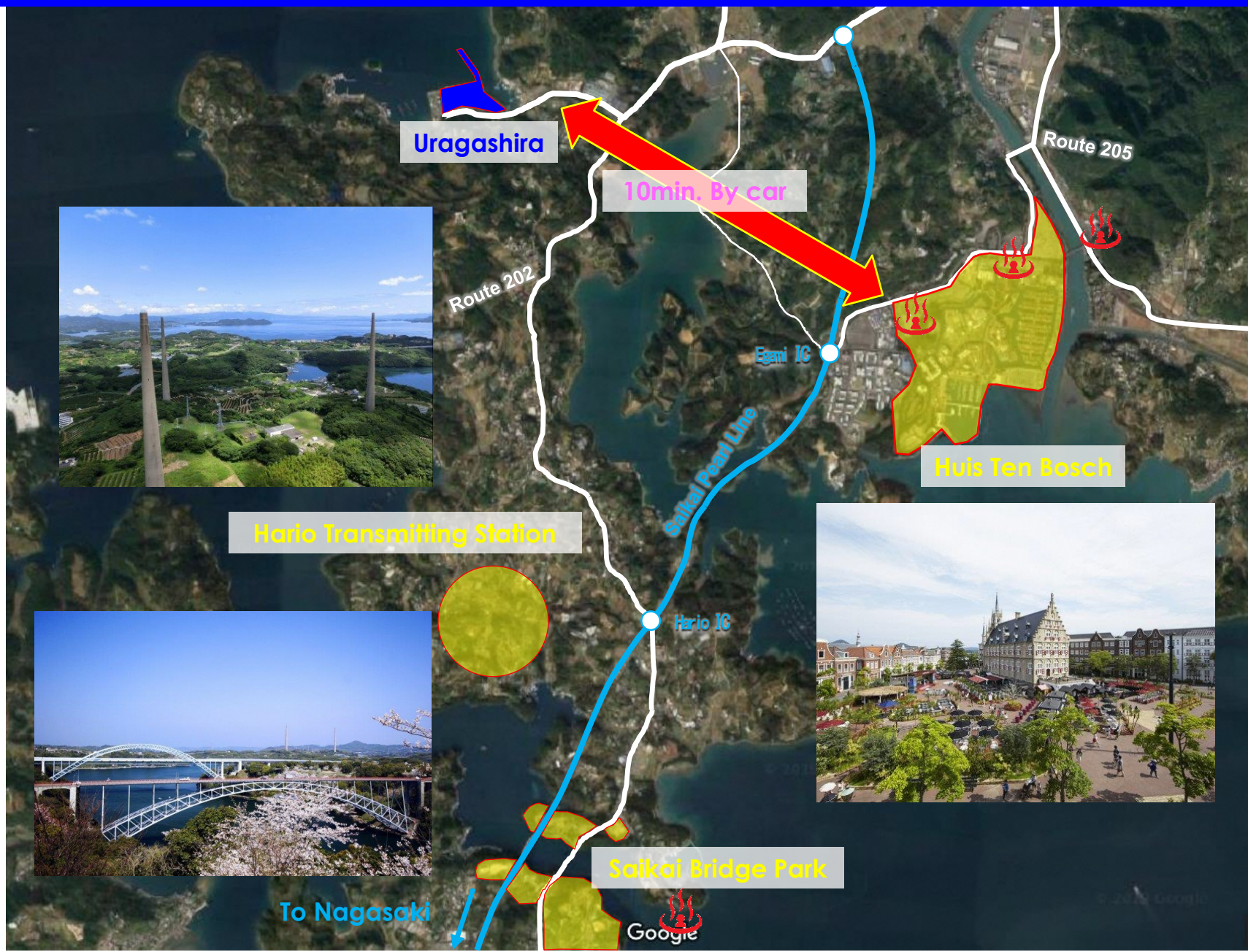

Affecting Seascape Kujukushima

15min. drive from Sasebo Sta. to Kujukushima pearl sea resort



Kujukushima Pearl Sea Resort

Here you can enjoy more the view of Kujukushima filled with the beauty of nature, the blue of sky and sea.



Kujukushima sightseeing ship Pearl Queen



Kujukushima Dolphin Pool



Hands-on Pearl Removal



Nagushiyama Park

A famous Azalea park. The view of North Kujukushima from here is spectacular.



Tenkaiho

Gorgeous view of Kujukushima spreading out in a huge panorama. Famous for rapeseed blossoms in the spring and cosmos in the autumn.

For registration as world heritage Kuroshima • Tabira Church

50min. by boat from port of Ainoura to Kuroshima

50min. drive from Sasebo Sta. to Tabira Church

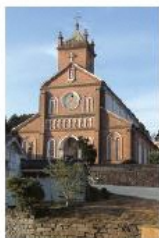

It's a symbol of this island with the history of the Hidden Christians. It was completed by all the believers in 1902, after 5 years construction, under the direction of Father Marmand. Its scale and high degree of perfection as church made with bricks in Meiji period is magnificent - the floor covered with bricks and tiles made in Arita, and stained glass made in France. It is said to have a lot of influence on the subsequent churches.



Kuroshima Church

Tabira Church

It's a majestic Romanesque church with red bricks, completed by the believers after 3 years of construction from 1915, under the instruction of Youkei Tetsuawa, Master Carpenter of church. It's said to be one of his representative works.



Saikai National Park, including Kujukushima, was designated in 1955 as Japan's eighteenth national park. 208 islands mostly unpopulated, are said to become the island chain the most highly concentrated in Japan. With mild seasons, the magnificence of these green islands and blue seas can be enjoyed year-round.

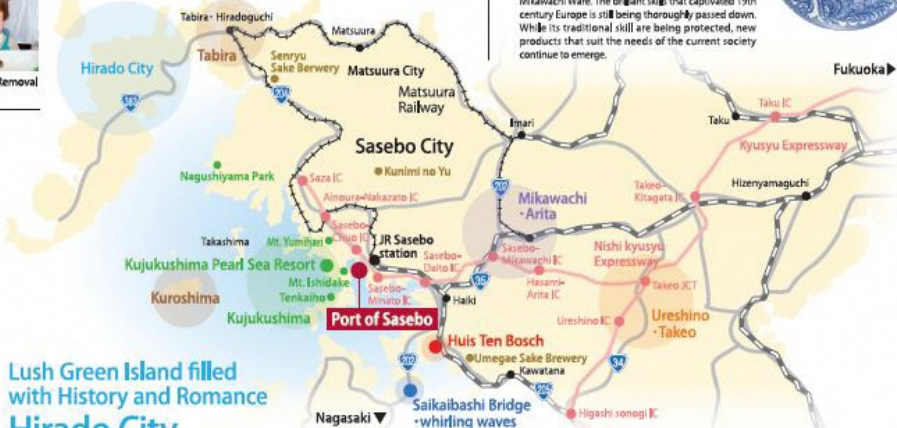

Lush Green Island filled with History and Romance Hirado City

50min. drive from Sasebo Sta. to Hirado Castle.



Scene with church and temples



Statue of Zheng Chenggong



Hirado Castle

Hirado, the first Japanese port of trade with Europe such as Netherlands and England, is a castle town holding the reproduced Dutch trading house and Hirado castle, which makes tourists feel the history of the era. In addition, it's known as the birthplace of Zheng Chenggong and many Chinese tourists visit here.



Matsura Historical Museum

Having the World Captivated Mikawachi • Arita

15min. drive from Sasebo Sta. to Mikawachi / 25min. drive to Arita



Mikawachi Ware

"Mikawachi Ware" (used to be referred to Hirado Pottery) that, developed as an official kiln of the Hirado Domain is the fruit of the fine and delicate techniques of artisans. The "Karakoe" that depicts children having fun following butterflies also originated from Mikawachi Ware. The brilliant skill that captivated 19th century Europe is still being thoroughly passed down. While its traditional skill are being protected, new products that suit the needs of the current society continue to emerge.



Arita Pottery Market



Mikawachi Pottery hand painting



Theme Park enjoyable for all Generations Huis Ten Bosch

20min. drive from Sasebo sta. / 20min. by rapid train.



Huis Ten Bosch is a town filled with flowers, light, games and music all year round. New features built around the themes of "health and beauty" and "robots" have also appeared. The park welcomes all visitors, families, couples and groups, from grandparents to grandchildren, to have a good time with its abundant entertainment. Come and enjoy the Only One & Number One philosophy of Huis Ten Bosch in action with experiences and sights you wouldn't find anywhere else!



Kingdom of Lights



Flower Festival



Fireworks No.1 in Kyushu festival



Kingdom of Games

Saikaibashi Bridge •whirling waves

25min. drive from Sasebo sta.



Built across the Hario Seto Strait, one of the three most rapid currents in Japan, Saikaibashi Bridge with parks is very familiar to local residents for its cherry blossoms and whirling waves.



Village of Hot Spring Warming your Body and Soul Ureshino • Takeo

35min. drive from Sasebo Sta. to Ureshino
40min. drive to Takeo (45min. By rapid train)



Ureshino Onsen Spa



Mifune Yama Park (Takeo City)



Hot spring tofu

Ureshino and Takeo flourished as post towns of Nagasaki Kaiko in Edo period. Steamy hot water in Ureshino including Sodium makes your skin fresh and youthful. "Onsen Yudofu" (soybean curd boiled with hot spring water) is also famous. The illuminations of Mifune-yama Park is also very popular.



Saikaibashi Onsen Yamanoren "Kunimi no Yu"